



SPARTAN



SUNWARD

# SWE18UF MINI-EXCAVATOR

◆ Total weight:1.88t

◆ Engine power:13.4kW/2200rpm

◆ Bucket capacity:0.04m<sup>3</sup>



- ◆ Tail-less slewing, moving arm deflection, easy operation in small spaces, digging ditch immediately to walls. It is easy for the whole machine to deal with a variety of complex working conditions.
- ◆ Equipped with high power engine with higher efficiency.
- ◆ The pipeline is neatly arranged to facilitate the maintenance of engine components.
- ◆ It has the automatic gear shifting function and is equipped with full hydraulic pilot control device combined with load-sensitive system, making the operation more precise and coordinated.
- ◆ The open driver cabin meeting TOPS and FOPS certification requirements has open vision field, and is safe and reliable.

### Parameters and performance of the main machine

|                               |                      |                                  |                     |
|-------------------------------|----------------------|----------------------------------|---------------------|
| Dimension (L×W×H)             |                      | mm                               | 3582x990x2350       |
| Overall weight                | With rubber track    | t                                | 1.88                |
|                               | With steel track     | t                                | \                   |
| Standard bucket capacity      |                      | m <sup>3</sup>                   | 0.04                |
| Bucket digging ability        |                      | kN                               | 21                  |
| Digging force of arm          |                      | kN                               | 9.83                |
| Max. traction                 |                      | kN                               | 16.7                |
| Deflection angle (boom)       |                      | °                                | 49°(Right)71°(Left) |
| Travel speed (Max/Min)        |                      | km/h                             | 3.5/2               |
| Gradeability                  |                      | °                                | 30                  |
| Ground pressure               |                      | kPa                              | 30.3                |
| Slewing speed                 |                      | rpm                              | 10                  |
| Engine                        | Brand                | KUBOTA                           |                     |
|                               | Model                | D1105-E4B-SWD-1S(Euro V / US IV) |                     |
|                               | Type                 | 4-stroke, in line, water cooling |                     |
|                               | Displacement         | L                                | 1.1                 |
|                               | Power/Rotation speed | kw/rpm                           | 14/2200             |
| Fuel tank capacity            |                      | L                                | 24.6                |
| Primary pump                  | Type                 | 1 variable piston pump           |                     |
|                               | Flow rate            | L/min                            | 51                  |
| Pressure of main relief valve |                      | MPa                              | 24.5                |
| Hydraulic oil tank capacity   |                      | L                                | 18.6                |

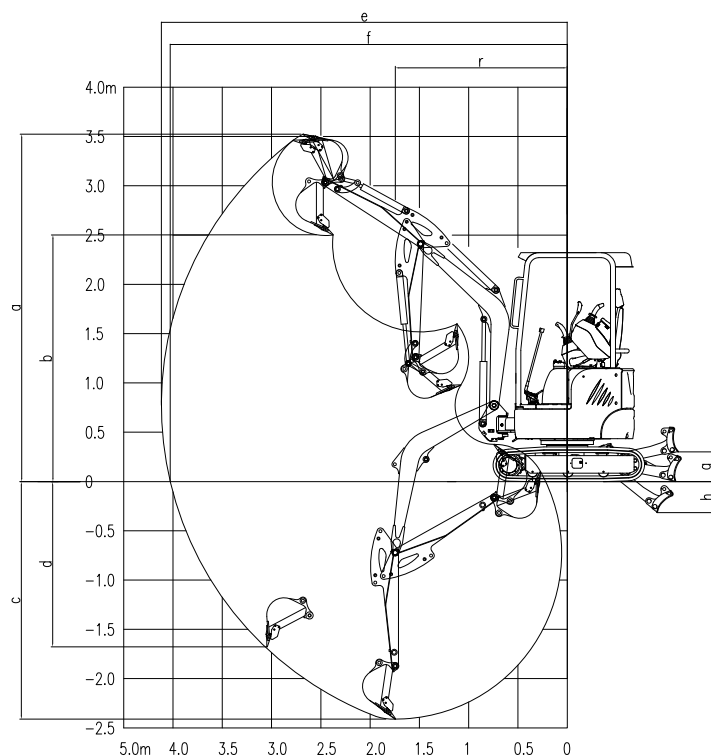

### Working range

|   |                                       |    |          |
|---|---------------------------------------|----|----------|
|   | Arm length                            | mm | 1150     |
| a | Max. digging height                   | mm | 3525     |
| b | Max. dumping height                   | mm | 2500     |
| c | Max. digging depth                    | mm | 2410     |
| d | Max. vertical digging depth           | mm | 1675     |
| e | Max. digging radius                   | mm | 4120     |
| f | Max. digging reach at ground level    | mm | 4030     |
| g | Max. lift height of the dozer blade   | mm | 235      |
| h | Max. digging depth of the dozer blade | mm | 300      |
| r | Min. swing radius                     | mm | 1745     |
|   | Bulldozer blade length×width          | mm | 1320x267 |

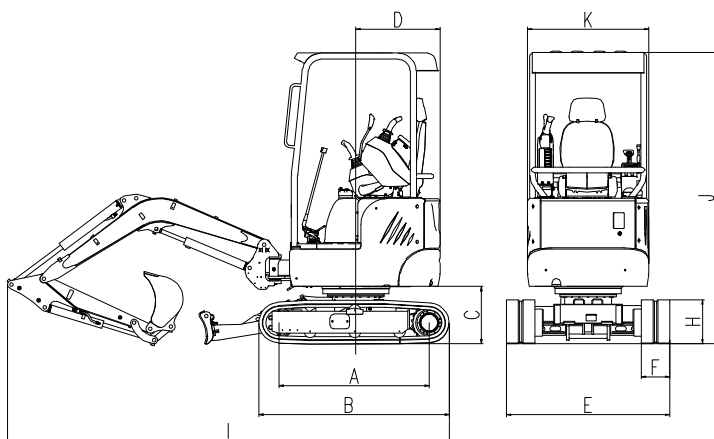

### Outline dimension

|   |                              |    |          |   |                          |    |      |
|---|------------------------------|----|----------|---|--------------------------|----|------|
| A | Wheel tread                  | mm | 1210     | G | Chassis ground clearance | mm | 160  |
| B | Total track length           | mm | 1540     | H | Track height             | mm | 352  |
| C | Ground clearance of platform | mm | 436      | I | Total length             | mm | 3582 |
| D | Platform tail slewing radius | mm | 680      | J | Cab roof height          | mm | 2350 |
| E | Chassis width                | mm | 990/1320 | K | Upper-structure width    | mm | 990  |
| F | Track width                  | mm | 230      |   |                          |    |      |

★ The above parameters may be different due to product upgrading.